

ST-9 (LED-4)

DIESEL FREE Mobile Lighting Tower



When looking for an advanced, industry-suited, diesel free mobile solar only lighting tower, our ST-9 (LED-4) has everything the market requires.

**9M
MAST**

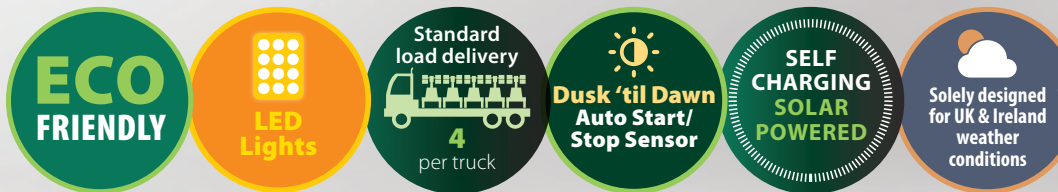

Optional extras:

- Vandal & Shatter-Proof Solar Panels
- Power Performance Telemetry
- GPS Telemetry Tracker



Features

- 4 x 100W LED fully adjustable 360° swivel and tilt lighting heads
- 9m vertical stainless steel mast
- 1440W roof mounted slide out high efficiency solar panels
- Heavy duty, deep cycle batteries
- Central lifting eye + side and rear fork pockets
- 4 x easy pull and drop fully adjustable stabiliser legs
- Complete on road-tow trailer

Benefits

- 2,400m² of illuminated light coverage
- For quick, simple and easy set-up
- Harvesting solar energy in all UK seasons and weather conditions with a nice and simple design to safely deploy and transport
- Ample power to support most site lighting applications all year round, with no other power support or back-up power required
- For flexible and safe loading and off-loading
- For nice, simple and easy usability & reduced set-up time
- For easy transport and on site use



Designed in the UK,
built in Italy

ST-9 (LED-4)

MHM LIGHTTOWER



Hinged lifting eye

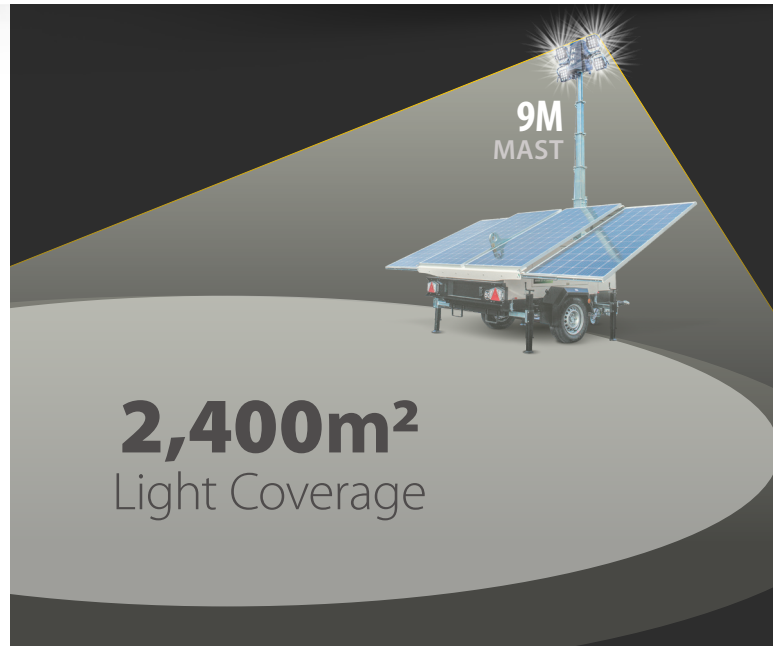

9M
MAST

2,400m²
Light Coverage

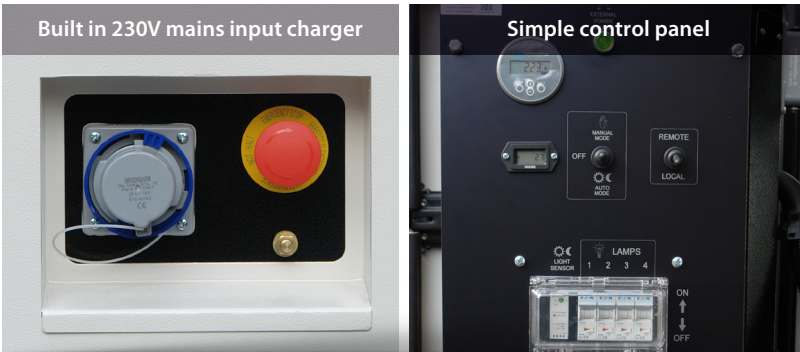

Built in 230V mains input charger

Simple control panel

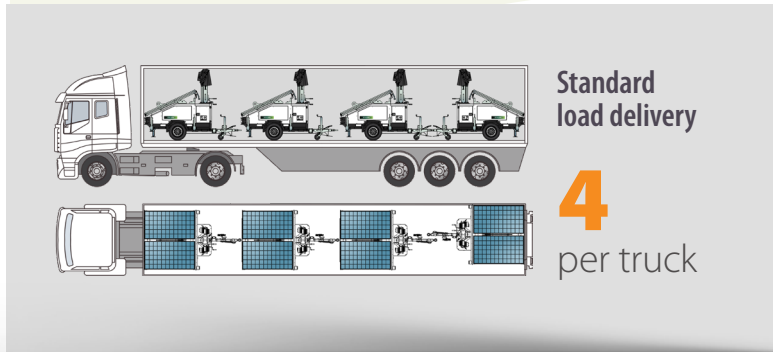

Standard
load delivery

4
per truck

Specification

Lighting

Lighting Head	4 x 100W LED
Max Mast Height	9m
Light Coverage	2,400m ²

Rotation	360°
Mast Type	Manual
Certified Wind Stability	110kmh / 70mph
IP Level	65

Solar Panel

Total Power	1440W
Type	4 x LG360

Solar Panel Deployment	Manual
Solar Charge Control	Victron MPPT 150/60V

Battery

Battery	AGM Sealed Lead Acid
Power Battery Pack	24V DC 800 Ah
Number of Batteries	8
Cooling	Air (Fan Assisted)

Protection	IP44
Expected Battery Cycle	500
Expected Battery 'Hours'	25,500
Safe Operating Temperature	0 to 40°C
CO ₂ Output Per Hour 'All Lights On'	0kg

Dimensions (Transport & storage mode, mast down, solar panel & stabiliser legs in)

Length: 3460 mm	Width: 2100 mm	Height: 2510 mm
-----------------	----------------	-----------------

Dimensions (Operation mode, mast up, solar panel & stabiliser legs out)

Length: 3460 mm	Width: 4170 mm	Height: 9000 mm
-----------------	----------------	-----------------

Weight

Total weight:	1390 kg
---------------	---------



The **zero CO₂ emissions** and **zero fuel usage** achieved by contractors when hiring **ST-9 Lighting Towers** can be included in the Contractors Sustainability Policy, which will help them to win Government and Local Authority Contracts.

For more details call **MHM TODAY**
on **0808 168 9099**

Email sales@mhmplant.com or visit us at www.mhmplant.com

MHM GROUP
The Preferred Supplier

Designed in the UK,
built in Italy

